



SMP Male Smooth Bore Connector Solder Attachment 2 Hole Flange Mount Pin Terminal, .282 inch Hole Spacing

RF Connectors Technical Data Sheet

PE44938

Configuration

- Smooth Bore SMP Male Connector
- DESC 94007
- 50 Ohms
- Straight Body Geometry
- Pin Interface Type
- Solder Attachment
- 2 Hole Flange

Features

- Gold Plated Beryllium Copper Contact
- Contact plating according to MIL-G-45204
- Blind Mate Connector

Applications

- General Purpose Test
- Rack and Panel Mount Applications

Description

Pasternack's PE44938 SMP male smooth bore 2 hole flange mount connector with solder attachment pin terminal is part of our full line of RF components available for same-day shipping. The Pasternack blind mate connector is ideal for applications where direct visual or tactile access to the connection point is not possible, for example, when two circuit boards need to be mated. This SMP 2 hole flange connector allows designers to create external connections on their product enclosures, and can be used in a variety of other rack mount and panel mount applications.

Our SMP male 2 hole flange connector PE44938 datasheet specifications and drawing with dimensions are shown below in this PDF. Pasternack's broad catalog of RF, microwave and millimeter wave connectors allows designers to configure and customize their signal connections however they like. Whether the need is to provide an I/O for a board design, or simply create a custom cable assembly configuration, Pasternack has the right connector for the job. Pasternack can also expertly build your custom cable assemblies for you and ship same-day.

Mechanical Specifications

Size	
Length	0.307 in [7.8 mm]
Width/Dia.	0.165 in [4.19 mm]
Height	0.4 in [10.16 mm]
Weight	0.242 lbs [109.77 g]

Click the following link (or enter part number in "SEARCH" on website) to obtain additional part information including price, inventory and certifications: [SMP Male Smooth Bore Connector Solder Attachment 2 Hole Flange Mount Pin Terminal, .282 inch Hole Spacing PE44938](#)



SMP Male Smooth Bore Connector Solder Attachment 2 Hole Flange Mount Pin Terminal, .282 inch Hole Spacing

RF Connectors Technical Data Sheet

PE44938

Material Specifications

Description	Material	Plating
Contact	Beryllium Copper	Gold MIL-G-45204
Insulation	PTFE	
Body	Passivated Stainless Steel	AMS-QQ-P-35

Environmental Specifications

Compliance Certifications (see [product page](#) for current document)

Plotted and Other Data

Notes:

Assembly Instruction

SMP Male Smooth Bore Connector Solder Attachment 2 Hole Flange Mount Pin Terminal, .282 inch Hole Spacing from Pasternack Enterprises has same day shipment for domestic and International orders. Our RF, microwave and millimeter wave products maintain a 99.4% availability and are part of the broadest selection in the industry.

Click the following link (or enter part number in "SEARCH" on website) to obtain additional part information including price, inventory and certifications: [SMP Male Smooth Bore Connector Solder Attachment 2 Hole Flange Mount Pin Terminal, .282 inch Hole Spacing PE44938](#)

URL: <https://www.pasternack.com/smp-male-standard-pin-terminal-connector-pe44938-p.aspx>

The information contained in this document is accurate to the best of our knowledge and representative of the part described herein. It may be necessary to make modifications to the part and/or the documentation of the part, in order to implement improvements. Pasternack reserves the right to make such changes as required. Unless otherwise stated, all specifications are nominal. Pasternack does not make any representation or warranty regarding the suitability of the part described herein for any particular purpose, and Pasternack does not assume any liability arising out of the use of any part or documentation.

PE44938 CAD Drawing

SMP Male Smooth Bore Connector Solder Attachment 2 Hole
Flange Mount Pin Terminal, .282 inch Hole Spacing

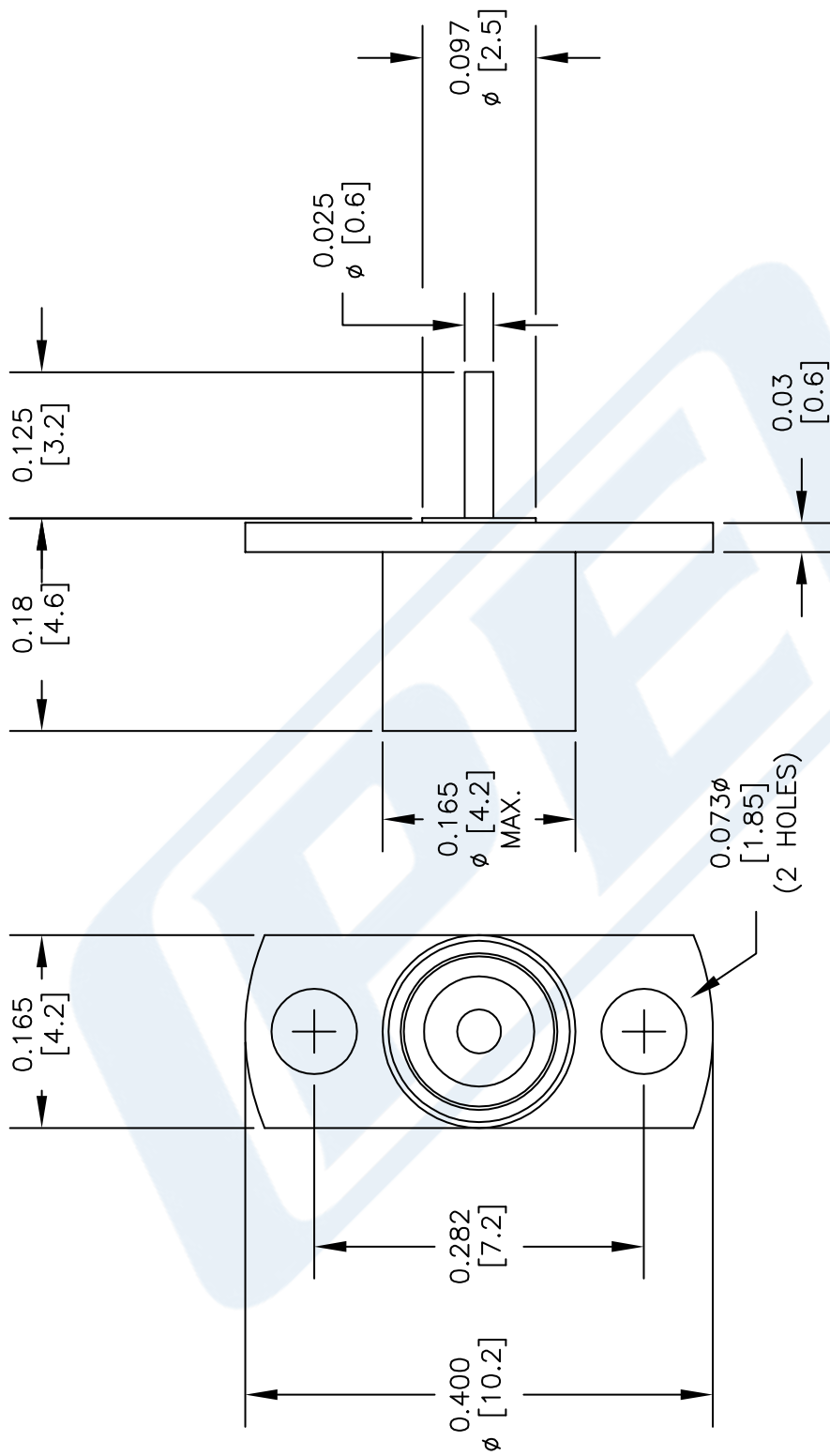

NOTES:
1. UNLESS OTHERWISE SPECIFIED ALL DIMENSIONS ARE NOMINAL.
2. ALL SPECIFICATIONS ARE SUBJECT TO CHANGE WITHOUT NOTICE AT ANY TIME.
3. DIMENSIONS ARE IN INCHES [mm].

DWG TITLE
PE44938

FSCM NO. 53919

CAD FILE 103013

SCALE N/A

SIZE A

150

PE PASTERNAK®
Pasternack Enterprises, Inc.
P.O. Box 16759 | Irvine | CA | 92623
Phone: (949) 261-1920 | Fax: (949) 261-7451
Website: www.pasternack.com | E-Mail: sales@pasternack.com