

SMA Male Connector Solder Attachment 0.042 inch
End Launch PCB, .020 inch x .010 inch Contact

RF Connectors Technical Data Sheet

PE44210

Configuration

- SMA Male Connector
- MIL-C-39012
- 50 Ohms
- Straight Body Geometry
- Connector Interface Types: .042 inch End Launch
- 5/16 in. Hex

Features

- Gold Plated Contact
- Contact plating according to MIL-G-45204

Applications

- General Purpose Test
- PCB Applications

Description

Pasternack's PE44210, SMA, Standard, connector with solder attachment for .042 inch End Launch PCB is part of our full line of RF components available for same-day shipping.

Our SMA male connector PE44210 datasheet specifications and drawing with dimensions are shown below in this PDF. Pasternack's broad catalog of RF, microwave and millimeter wave connectors allows designers to configure and customize their signal connections however they like. Whether the need is to provide an I/O for a board design, or simply create a custom cable assembly configuration, Pasternack has the right connector for the job. Pasternack can also expertly build your custom cable assemblies for you and ship same-day.

Impedance	50	Ohms
-----------	----	------

Mechanical Specifications

Size

Length	0.69 in [17.45 mm]
Width	0.38 in [9.53 mm]
Height	0.31 in [7.92 mm]
Weight	0.01 lbs [4.08 g]
Mating Torque	5 in-lbs [0.57 Nm]

Material Specifications

Description	Material	Plating
Contact		Gold MIL-G-45204
Insulation	Teflon	
Body	Brass	Gold MIL-G-45204
Coupling Nut	Brass	Gold MIL-G-45204

Click the following link (or enter part number in "SEARCH" on website) to obtain additional part information including price, inventory and certifications: [SMA Male Connector Solder Attachment 0.042 inch End Launch PCB, .020 inch x .010 inch Contact PE44210](#)



SMA Male Connector Solder Attachment 0.042 inch
End Launch PCB, .020 inch x .010 inch Contact

RF Connectors Technical Data Sheet

PE44210

Environmental Specifications

Temperature

Operating Range

-65 to +165 deg C

Compliance Certifications (see [product page](#) for current document)

Plotted and Other Data

Notes:

SMA Male Connector Solder Attachment 0.042 inch End Launch PCB, .020 inch x .010 inch Contact from Pasternack Enterprises has same day shipment for domestic and International orders. Our RF, microwave and millimeter wave products maintain a 99.4% availability and are part of the broadest selection in the industry.

Click the following link (or enter part number in "SEARCH" on website) to obtain additional part information including price, inventory and certifications: [SMA Male Connector Solder Attachment 0.042 inch End Launch PCB, .020 inch x .010 inch Contact PE44210](#)

URL: <https://www.pasternack.com/sma-male-standard-0.042-end-launch-connector-pe44210-p.aspx>

The information contained in this document is accurate to the best of our knowledge and representative of the part described herein. It may be necessary to make modifications to the part and/or the documentation of the part, in order to implement improvements. Pasternack reserves the right to make such changes as required. Unless otherwise stated, all specifications are nominal. Pasternack does not make any representation or warranty regarding the suitability of the part described herein for any particular purpose, and Pasternack does not assume any liability arising out of the use of any part or documentation.

PE44210 CAD Drawing

SMA Male Connector Solder Attachment 0.042 inch End
Launch PCB, .020 inch x .010 inch Contact

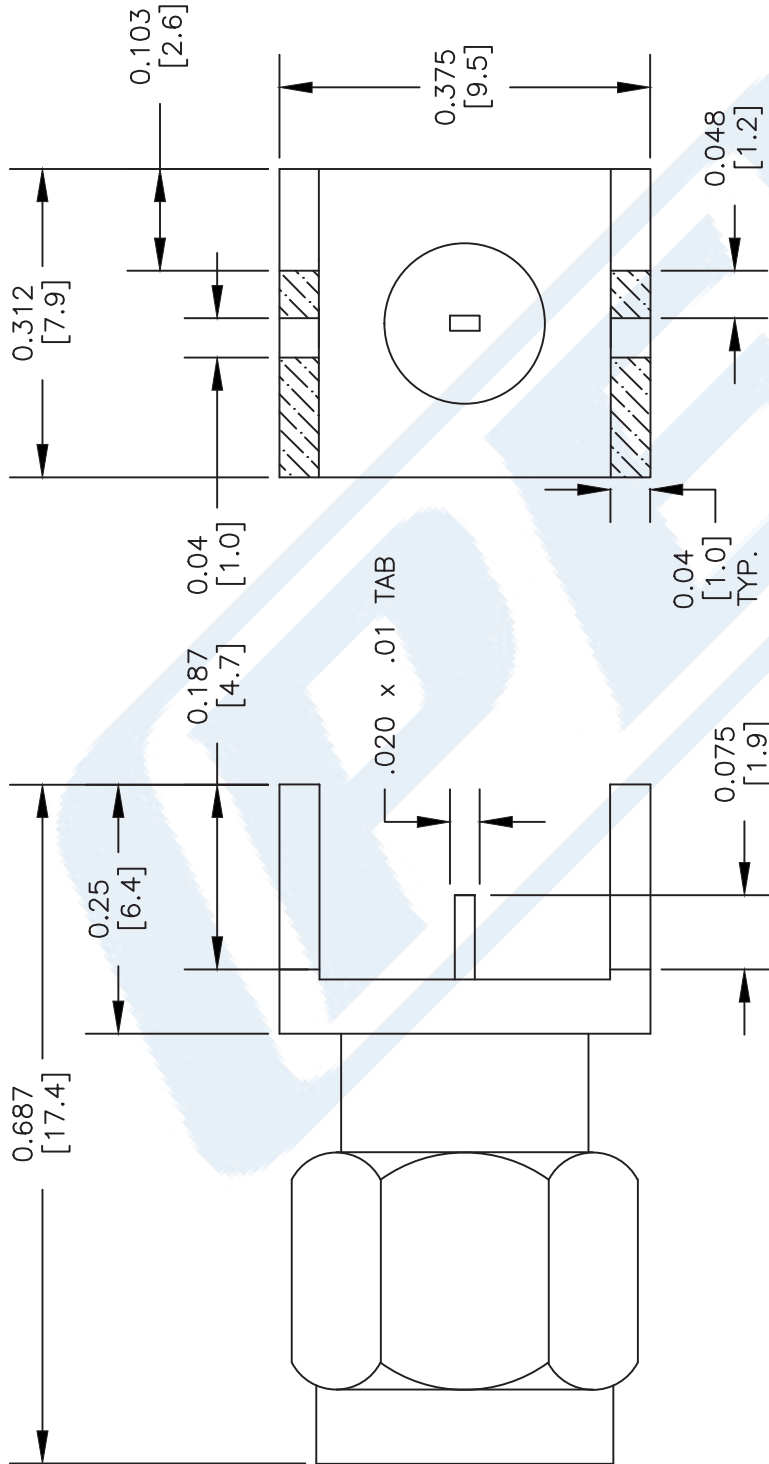

NOTES:
1. UNLESS OTHERWISE SPECIFIED ALL DIMENSIONS ARE NOMINAL.
2. ALL SPECIFICATIONS ARE SUBJECT TO CHANGE WITHOUT NOTICE AT ANY TIME.
3. DIMENSIONS ARE IN INCHES [mm].

DWG TITLE

PE44210

FSCM NO. 53919

CAD FILE 071202

SCALE N/A

SIZE A

XXXX



Pasternack Enterprises, Inc.
P.O. Box 16759 | Irvine | CA | 92623
Phone: (949) 261-1920 | Fax: (949) 261-7451
Website: www.pasternack.com | E-Mail: sales@pasternack.com